

STAINLESS STRAP REMOVAL

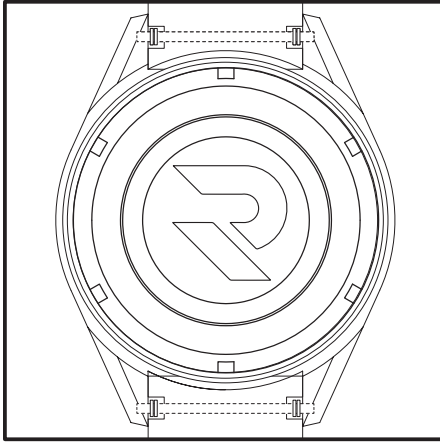

(1) LOCATE THE SPRING BAR ON THE BACK SIDE OF THE WATCH CASE.

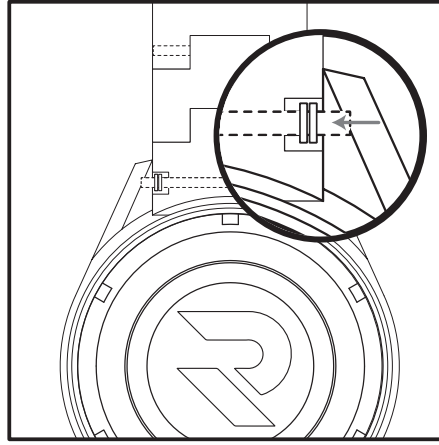

(2) COMPRESS THE SPRING BAR PISTON INWARDS TO RELEASE EITHER SIDE.

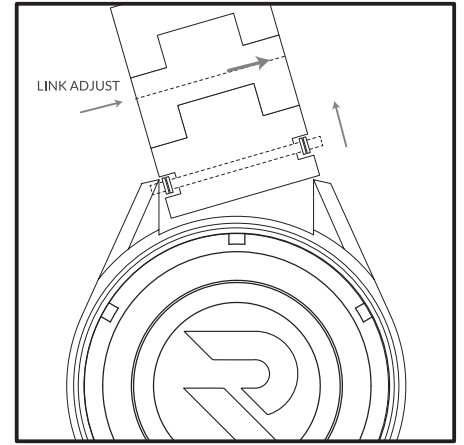

(3) ONCE PISTON IS RELEASED FROM THE PIVOT HOLE, STEEL STRAP CAN BE REMOVED.

TIP: USE SPRING BAR TOOL TO PUSH STRAP PIN IN THE DIRECTION OF THE MARKING TO RELEASE LINKS FOR ADJUSTMENT.

LEATHER STRAP REMOVAL

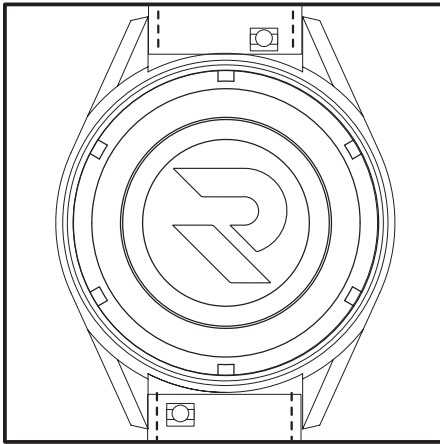

(1) LOCATE THE SPRING BAR ON THE BACK SIDE OF THE WATCH CASE.

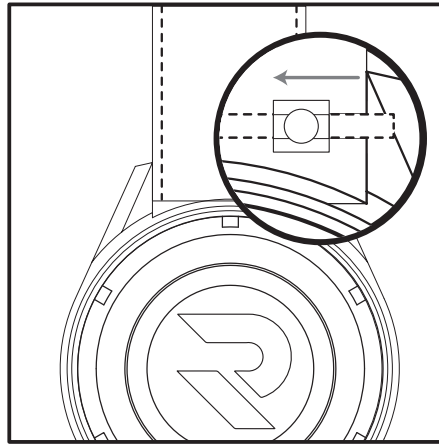

(2) PUSH THE QUICK RELEASE KNOB INWARDS TO RELEASE EITHER SIDE.

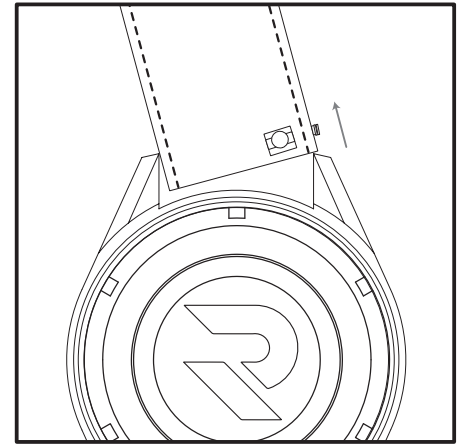

(3) ONCE PISTON IS RELEASED FROM THE PIVOT HOLE, STEEL STRAP CAN BE REMOVED.

NATO STRAP INSTALL

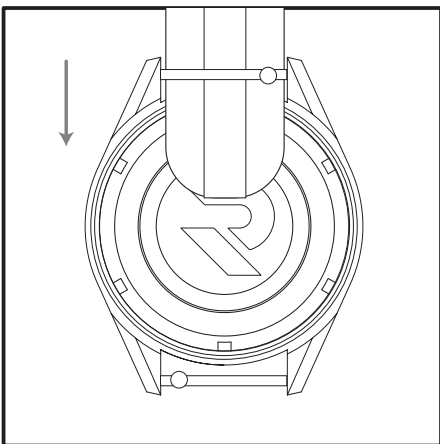

(1) POSITION SPRING BARS INTO LUGS OF WATCH CASE AND PUT CASEBACK SIDE FACING UP. THREAD NATO STRAP THROUGH, OVER THE SPRING BARS TOWARDS OPPOSITE SIDE.

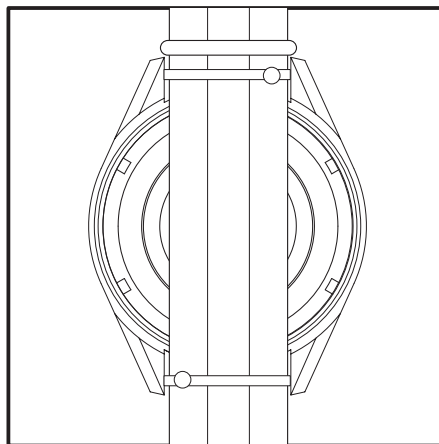

(2) ONCE THREAD COMPLETELY THROUGH BOTH SPRING BARS, HARDWARE ANCHORS THE STRAP INTO POSITION, READY FOR USE.

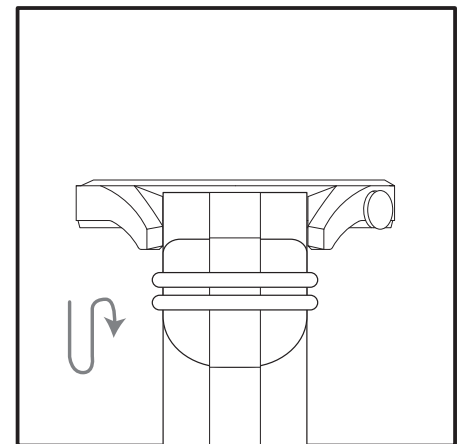

(3) FOLD EXCESS LENGTH BACK INTO HARDWARE FOR A REFINED FINISH.